

FA • Robotic Automation Products

Application Examples

For Automotive • Semiconductor • LCD Panel
Electronics • Precision Equipment Industries

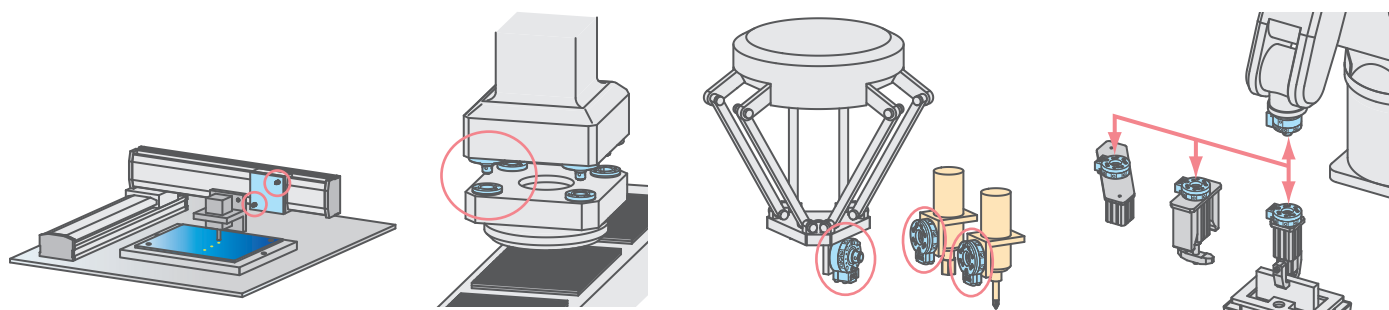

More Automation Solutions

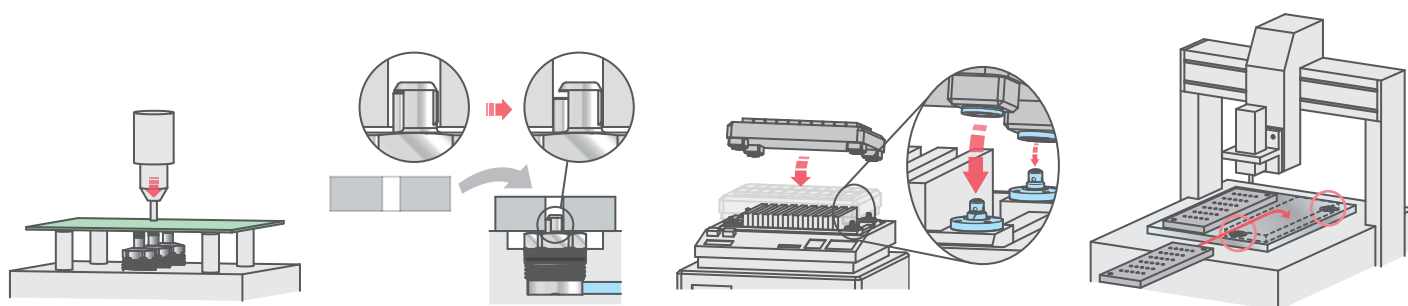

Product Line-Up

Locating

Clamp

Coupler

Robotic Hand Changer

Model SWR

No Backlash High Accuracy • High Rigidity • Long Life

Locating Repeatability: $3\mu\text{m}$ Compact and Easy to Use

Allowable Load (at Pneumatic Pressure 0.5MPa): 3kg / 7kg / 12kg / 25kg / 50kg / 75kg / 120kg



Air + Spring Lock / Air Release

Locating

Clamp

Pneumatic Location Clamp

Model SWT

Locates and Clamps Simultaneously

Locating Repeatability: $3\mu\text{m}$

Clamping Force (at Pneumatic Pressure 0.5MPa): 0.8kN / 1.5kN / 2.3kN / 3.3kN / 5.1kN



Air + Spring Lock / Air Release

Locating

Clamp

Screw Locator

Model VXF

NEW

M4/M5 sizes are added to the line-up!
Most Suitable for Locating Small Plates

Simple Manual Setup High Accuracy Locating of Pallets/Plates

Locating Repeatability: $3\mu\text{m}$ Most Suitable for Pallets and Equipments Requiring High Accuracy Locating

Bolt Size : M4 / M5 / M6 / M8 / M10 / M12 / M16



Manual Lock / Manual Release

Locating

Expansion Locating Pin Smaller Diameter Model

Model VRA/VRC

Zero Clearance Between Expansion Pin and Reference Hole

Locating Repeatability: $3\mu\text{m}$ Durability of Ten Million Cycles (When using VRA)

Workpiece Hole Diameter: $\phi 3$ / $\phi 4$ / $\phi 5$ / $\phi 6$



Spring Lock / Air Release

Locating

Pneumatic Expansion Locating Pin

Model WM

Zero Clearance with High Accuracy Locating Pin

Locating Repeatability: $3\mu\text{m}$

Workpiece Hole Diameter: $\phi 8$ / $\phi 9$ / $\phi 10$ / $\phi 12$ / $\phi 13$ / $\phi 15$ / $\phi 16$ / $\phi 18$ / $\phi 20$



Air + Spring Lock / Air Release

Locating

Manual Expansion Locating Pin

Model VX

Zero Clearance with High Accuracy Manual Locating Pin

Locating Repeatability: $5\mu\text{m}$

Workpiece Hole Diameter: $\phi 8$ / $\phi 10$ / $\phi 12$ / $\phi 16$ / $\phi 20$



Manual Lock / Manual Release

Clamp

Robotic Hand

Model WPH/WPP/WPQ

Compact with High Gripping Force

Most Suitable for Using with Robotic Hand Changer



Parallel Robotic Hand Gripper
Model WPH



Three-Jaw Chuck
Model WPP



Two-Jaw Chuck
Model WPQ

Air Lock / Air Release

Clamp

High-Power Pneumatic Clamp

Model WHE/WCE/SWE

Higher Clamping Force and Holding Force with Mechanical Lock and Pneumatic Pressure

Clamping Force which Withstands the Load with Holding Force does not Distort the Workpiece.



Swing Clamp
Model WHE



Link Clamp
Model WCE



Hole Clamp
Model SWE

Air Lock / Air Release

Support

Auto Backup Pin

Model WDC

Prevents Chattering and Distortion Counter to the Load

Pin Touches Workpiece Softly and Stops to Provide Support



Spring Lock / Air Release

Support

High-Power Pneumatic Work Support

Model WNC

Firmly Supports the Workpiece and Prevents Chattering/Distortion

The World's First Collet-Style Work Support with Pressure Range of 0.25~0.7MPa.



Air Lock / Spring Release

Coupler

Auto Coupler

Model JVA/JVB JVC/JVD JVE/JVF

Compact Coupler to Connect Hydraulic/Pneumatic Circuits

Connection Stroke: 1mm Commonly Used with Screw Locator and Pneumatic Location Clamp



Control

Air Sequence Valve

Model BWD

Actuates Multiple Air Actuators in Sequence Without Electricity.

Delay Time: 1~10sec Most Suitable for Electricity-Free Environments



Kosmek works to meet the needs of every customer,
developing and producing innovative products.

<http://www.kosmek.co.jp>

We have various types of hydraulic and pneumatic products.
Please let us know your requirements, and we will make it happen.

For further information of each product, please refer to
"FA • Robotic Automation Products Complete Catalog".
Please contact us or request it from our website.

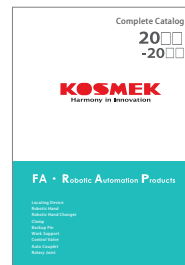

FA • Robotic Automation Products
Complete Catalog
Catalog No.FA0020□-□-GB

Application Examples

Category

■ Transfer

■ Deburring

■ Soldering, Sealing

■ Welding

■ Transfer

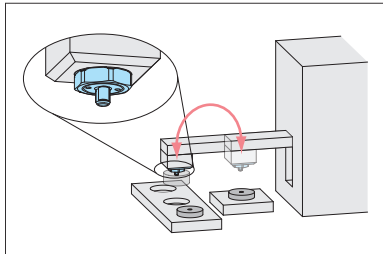

Expands to hold the workpiece hole.
For Pick-and-Place of Table Robots

Model **VRA/VRC** **WM**

■ Transfer

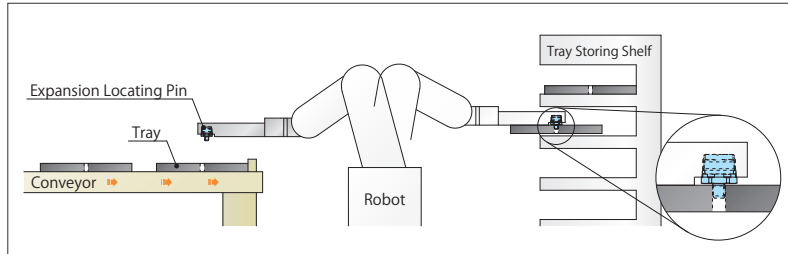

Clamps the tray hole and transfers it to the storing shelf.

Model **VRA/VRC** **WM**

■ Transfer

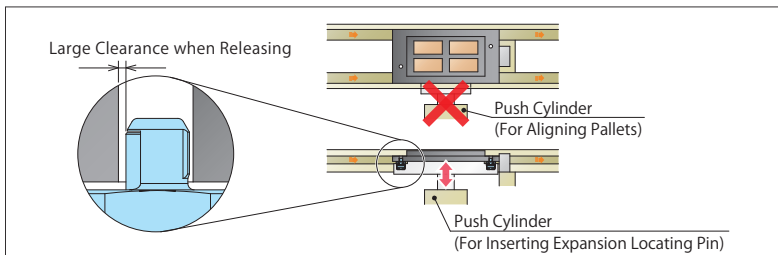

Expansion locating pin allows for easy pallet loading/unloading.
It prevents transfer error of conveyors.

Model **VRA/VRC** **WM**

■ Transfer

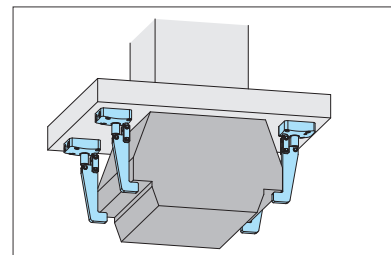

Prevents workpiece from falling
with holding force even at 0MPa.

Model **SWE** **WCE**

■ Transfer

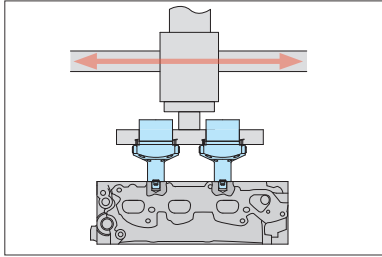

Minimize the Transfer Equipment by clamping workpiece hole.

Model **SWE**

■ Transfer

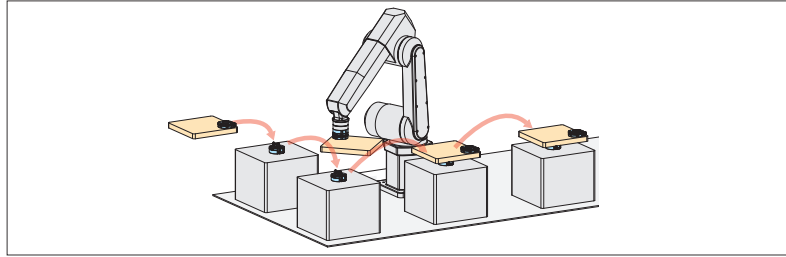

Robotic Hand Changers mounted to the pallets.
It enables not only tool change, but also pallet transfer.

Model **SWR** **SWT** **WVS**

■ Transfer

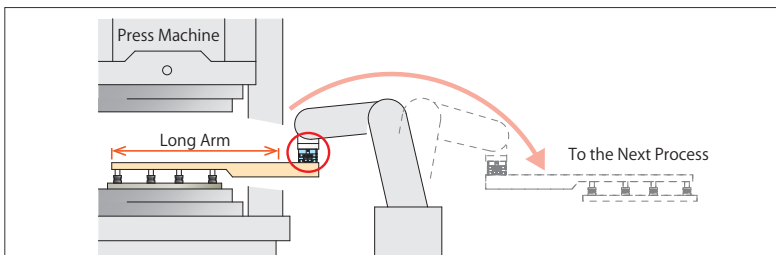

High accuracy locating of Robotic Hand Changer reduces fluctuation of press machine transfer arm and prevents errors.

Model **SWR**

■ Transfer

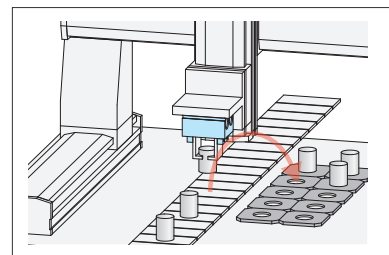

Long Stroke Robotic Hand allows for transferring various kinds of workpieces.

Model **WPH** **WPP** **WPQ**

■ Deburring

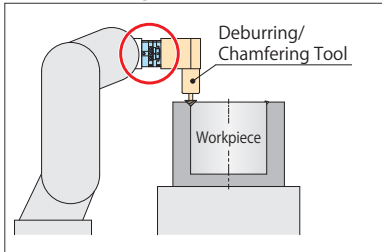

High accuracy robotic tool changer improves machining accuracy.

Model **SWR**

■ Deburring

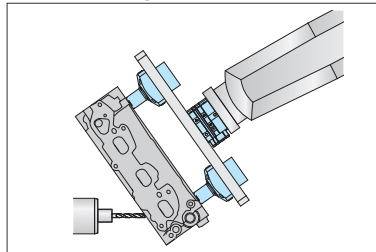

Clamps the workpiece by holding its holes. No Interference, Smooth Deburring

Model **SWR** **SWE**

■ Deburring

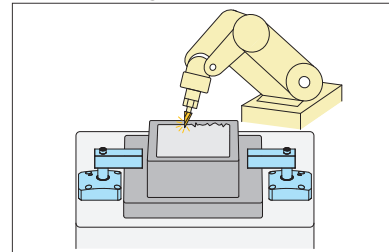

Clamps the workpiece with holding force. Scratches on the workpiece will be minimized.

Model **WHE** **WCE**

■ Soldering



Soldering accuracy will be improved by high accuracy robotic tool changer.

Model **SWR**

■ Sealing



High accuracy robotic tool changer improves sealing accuracy.

Model **SWR**

■ Welding

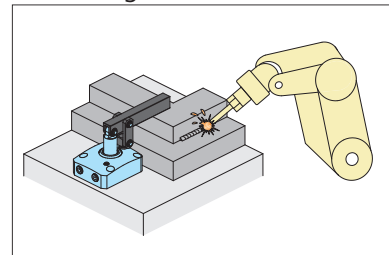

Clamp Automation
※ Spatter measurement is required.

Model **WHA** **WCA**

Application Examples

Category

■ Washing

■ Assembly

■ Press Fit

■ Test

■ Washing

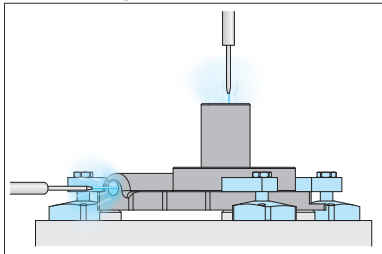

Clamps the workpiece with holding force. Scratches on the workpiece will be minimized.

Model **WHE** **WCE**

■ Washing

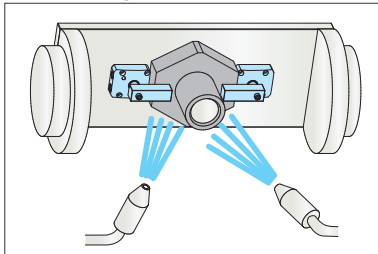

Washing Machine Automation with Automatic Clamps

Model **WHA** **WCA**

■ Assembly

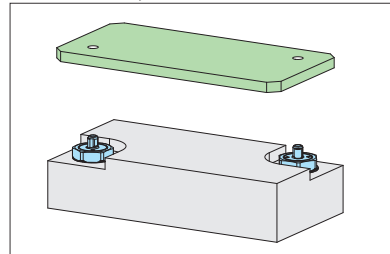

High accuracy locating facilitates precision work.

Model **VRA/VRC** **WM**

■ Assembly

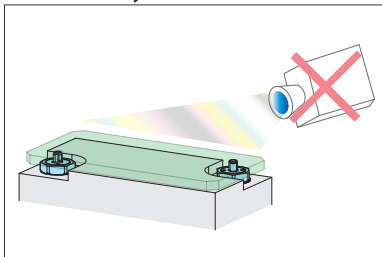

Cost Reduction in Adjustment Equipment with High Accuracy Locating

Model **VRA/VRC** **WM**

■ Assembly

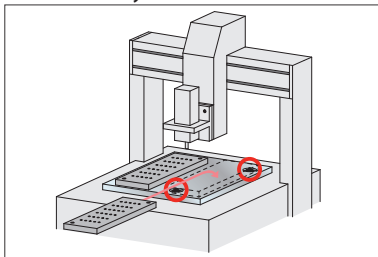

Improves locating accuracy during pallet change.

Model **WM** **VX** **VXF**

■ Assembly

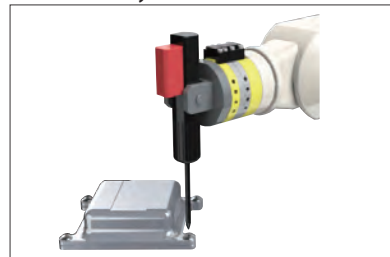

Without backlash, robotic tool changer facilitates screw tightening and reduces defects.

Model **SWR**

■ Assembly

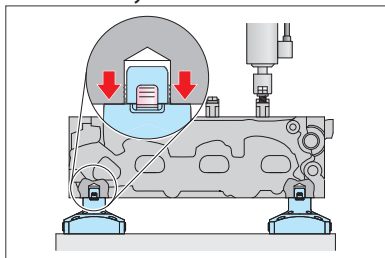

Clamps the workpiece by holding its holes.
Smooth Assembly with No Interferes

Model **SWE**

■ Assembly

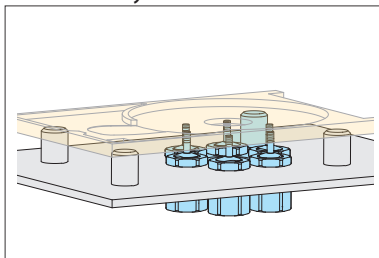

Supports press fitting during HDD assembly, preventing deformation.

Model **WDC**

■ Assembly

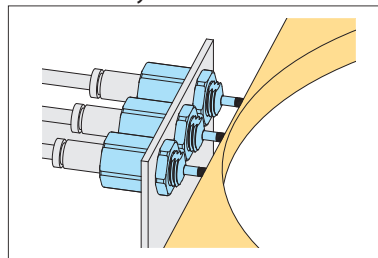

Supports thin-walled part preventing deformation and cracking.

Model **WDC WNC**

■ Assembly

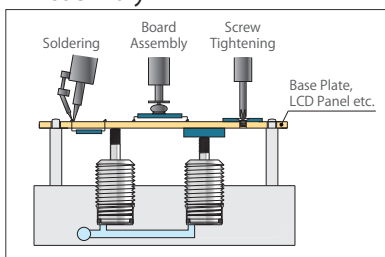

Supports the bottom of the circuit board.
Prevents backlash during board assembly.

Model **WDC**

■ Assembly

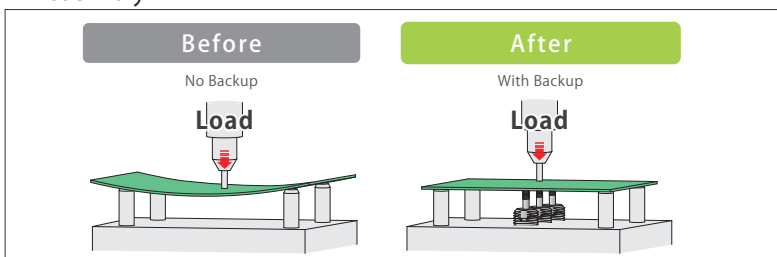

Supports and backups the workpiece from the bottom
preventing deformation caused by various kinds of loads.

Model **WDC WNC**

■ Press Fit

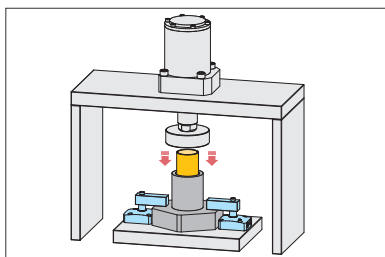

Press Fit Automation with Automatic Clamps

Model **WHE WHA**

■ Press Fit

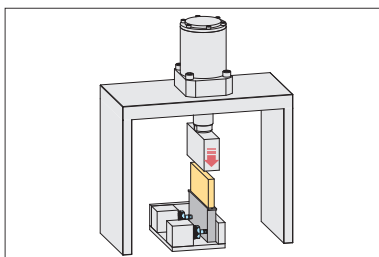

Supports the thin walled part, preventing deformation caused by press fit.

Model **WNC**

■ Test

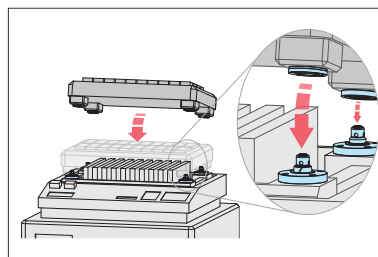

Improves accuracy of the semiconductor test device. Locates cassette with high accuracy.

Model **SWT WVS**

■ Test

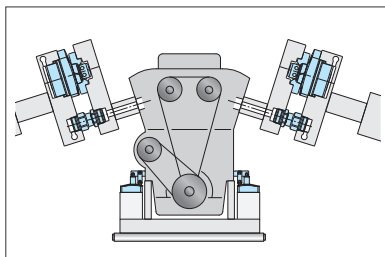

Engine Test Device Tool Change
Standardization of Test Device

Model **SWT SWR JV**

■ Test

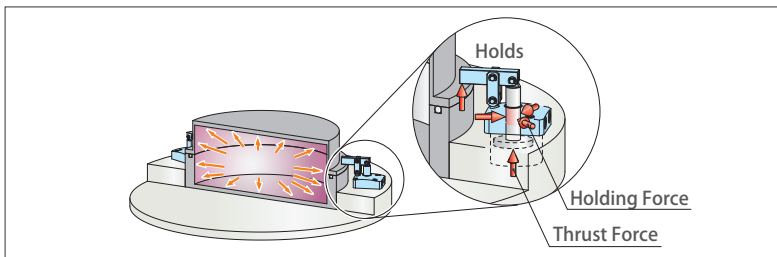

Securely holds the pressure container for leak test
with clamping force and holding force.

Model **WHE WCE**

Application Examples

Robot Examples

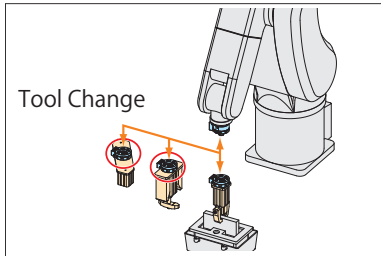

Articulated Robot
Standardized Tool Change

Model **SWR**

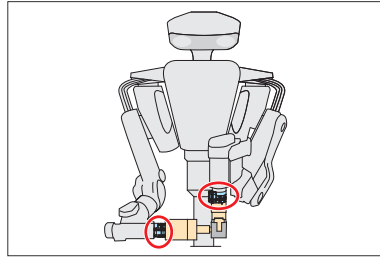

Humanoid Robot
End of Arm Tool Change

Model **SWR**

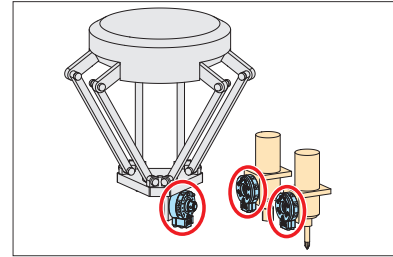

Parallel Link Robot
Screw Tightening Tool Change

Model **SWR**

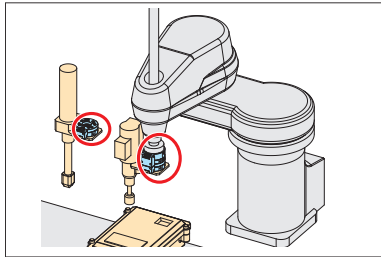

Scara Robot
Nut Runner Tool Change

Model **SWR**

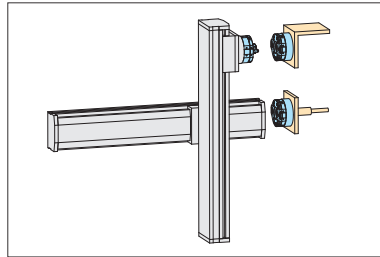

2-Axis Cartesian Coordinate Robot
Test Device Tool Change

Model **SWR**

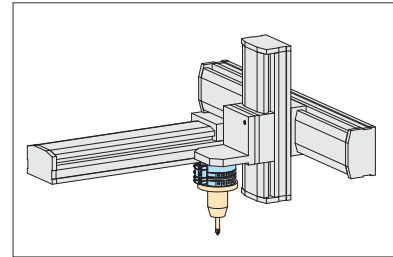

3-Axis Cartesian Coordinate Robot
Tool Change

Model **SWR**

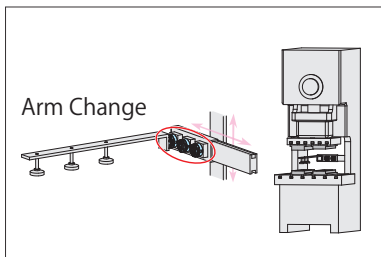

Press Machine
Transfer Arm Change

Model **SWR**

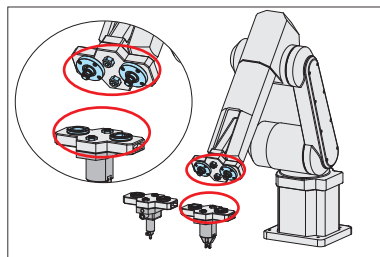

Large Robot
Design various kinds of robotic hands.

Model **SWR** **JV**

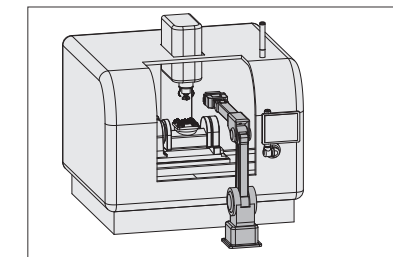

Articulated Robot
Unloading Machine Tool Pallets/Workpieces

Model **SWR**

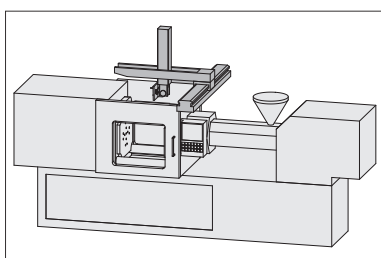

Injection Molding Machine
Take-Out Robot

Model **SWR**

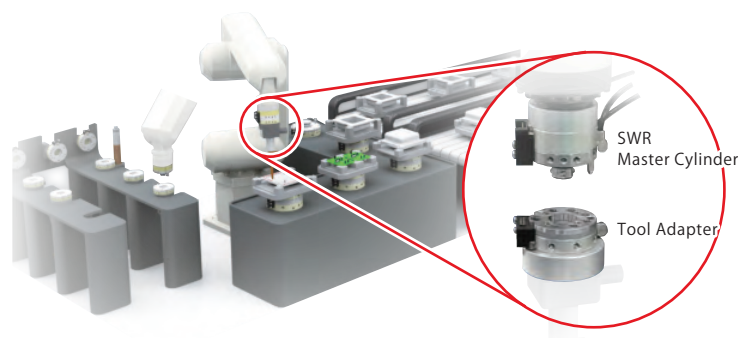

High-precision Robotic Hand Changer enables multiple functions of robots and setup time reduction. It enhances the productivity of automated production line.

Application Examples

Setup Improvement Examples

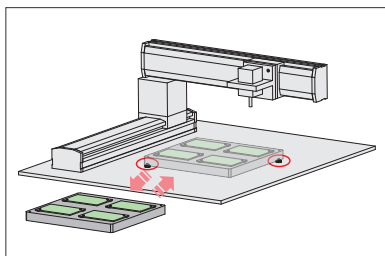

Cartesian Coordinate Robot
High-Accuracy Pallet Setup

Model **VRA/VRC** **WM** **VX**

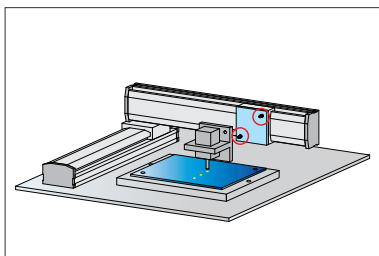

Cartesian Coordinate Robot
High-Accuracy Light Tool Setup

Model **WM** **VX**

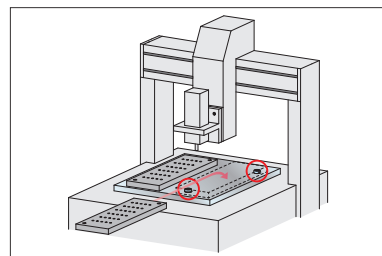
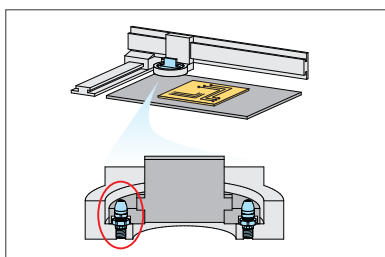

Table Robot
High-Accuracy Pallet Setup

Model **WM** **VX** **VXF**



Ink-Jet Device
Head Change

Model **VX** **VXF**

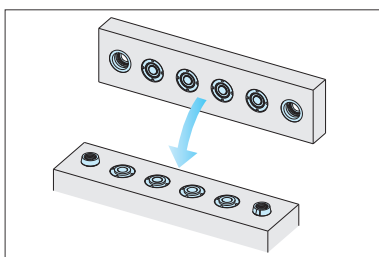

During Pallet Change
Locates with VXF, connects circuits with JVA/B

Model **VXF** **JVA/B**

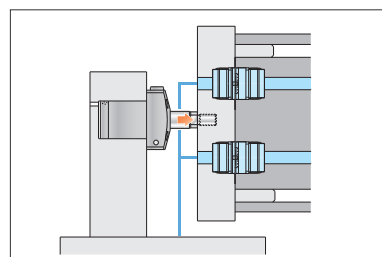

Circuit Connection Automation

Model **JV□**

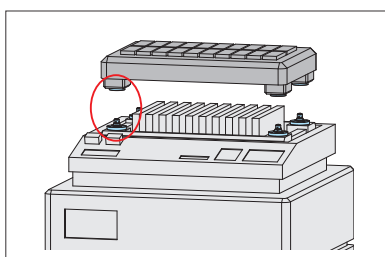

Semiconductor Test Device
High-Accuracy Cassette Setup

Model **SWT** **WVS**

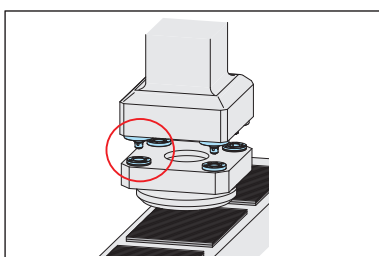

Production Line of LCD Panels

Model **SWT** **WVS**

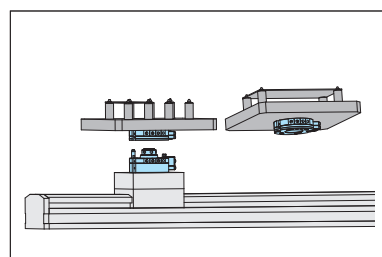

Single Axis Robot Pallet Change

Model **SWR**

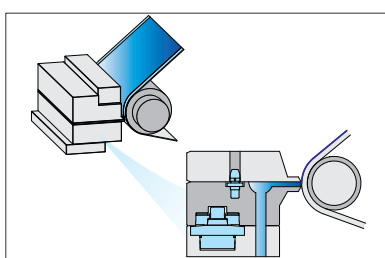

Die Coater
Setup During Washing

Model **SWT** **VX** **VXF**

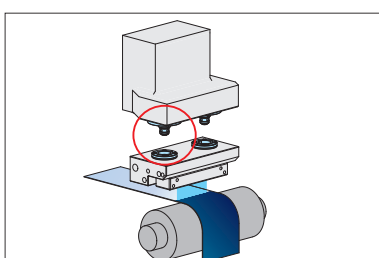

Coating and Coater Head

Model **SWT**



Kosmek Robotic Hand Changer is used for

Humanoid Robot Tool Change

Application Example

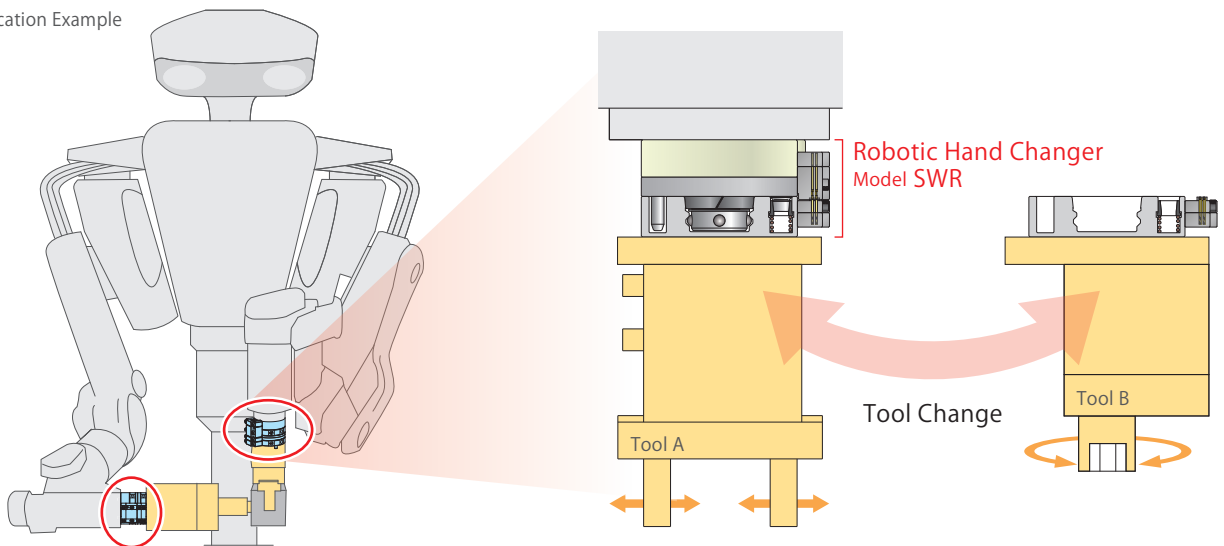

6 Reasons to Choose **KOSMEK**

Built-in Spring

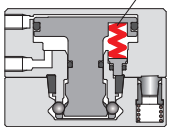

Safe • Anti-Falling of Tool

Even without air supply, built-in spring maintains mating condition which prevents tool from falling.



115g

Light Weight • Compact

Suitable for robotic hands which are near the weight limit.
Light Weight yet Large Load Capacity!!

※ It shows the weight of SWR0030 without the electrode.

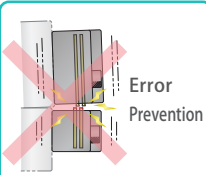

Enhances Work Efficiency

No backlash on mating part. Highly reliable electrode prevents momentary stop caused by communication error.

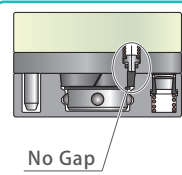

No Backlash on Mating Part

No backlash (clearance) on mating part and most suitable for high load and high accuracy operation.

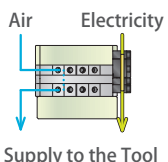

Connect Air/Electricity to the Tool

By air port and electrode, it is able to connect air and electricity to the tool side. Electrode is selectable from solder terminal, D-SUB connector and power transmission connector.

Locating Repeatability
0.003mm

Prevents Fluctuation

Locating repeatability of tool change is 0.003mm. Reduces the fluctuation of hand tool and conducts high accuracy operation.

Kosmek Robotic Hand Changer is used for both

Transfer Robots and Pallet Locating

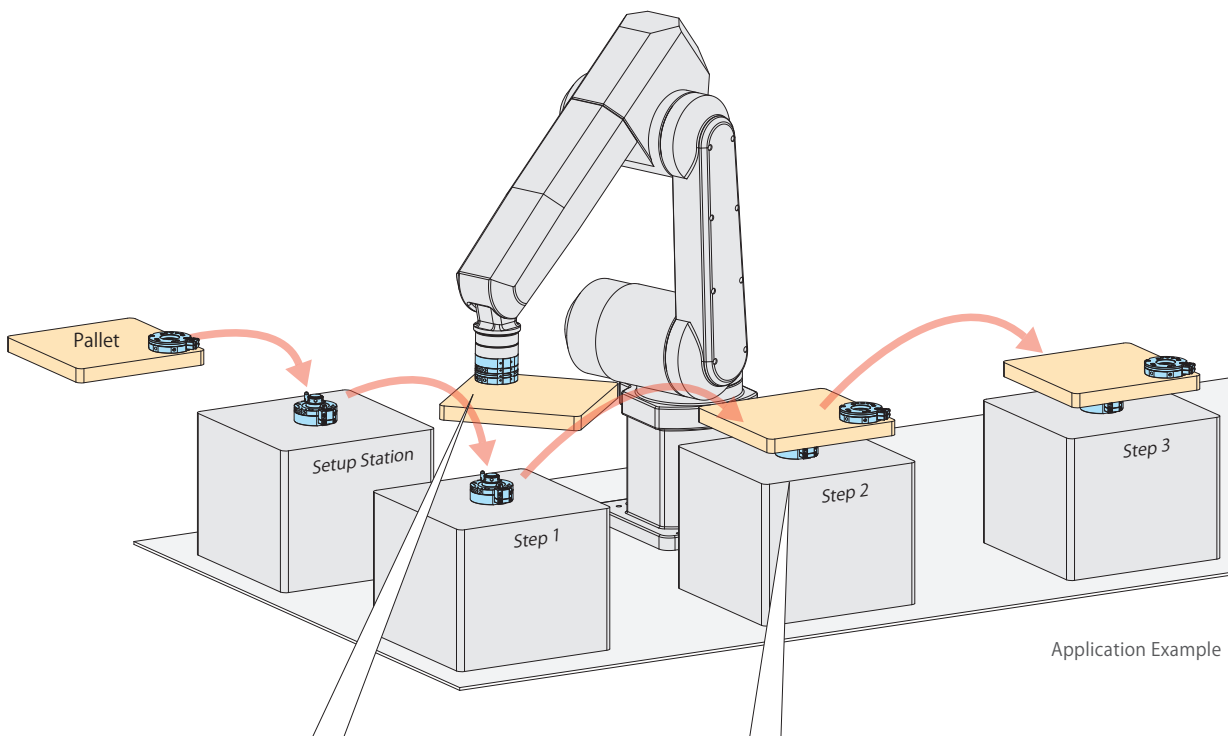

For Transfer Robot

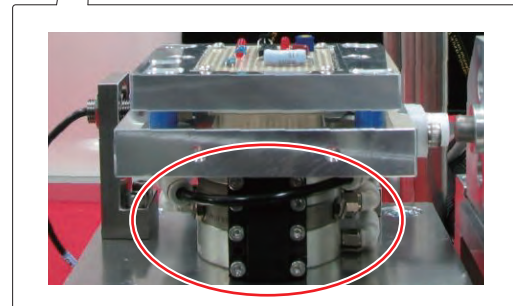

For Locating Pallets

High Accuracy

Locating Repeatability : within $3\mu\text{m}$

No backlash on mating part with the dual surface contact of movable taper sleeve.

Safety

Pallet Fall Prevention

Mechanical locking system maintains mating condition with built-in spring.

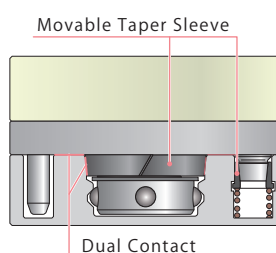

High Accuracy Locating with Dual Contact

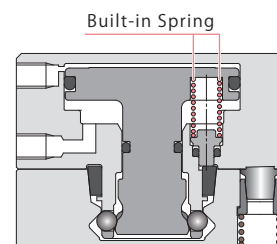

Built-in spring maintains the locked state.



Model SWR

Kosmek Robotic Hand Changer is used for

Deburring • Chamfering Robots for Aircraft Engine Components

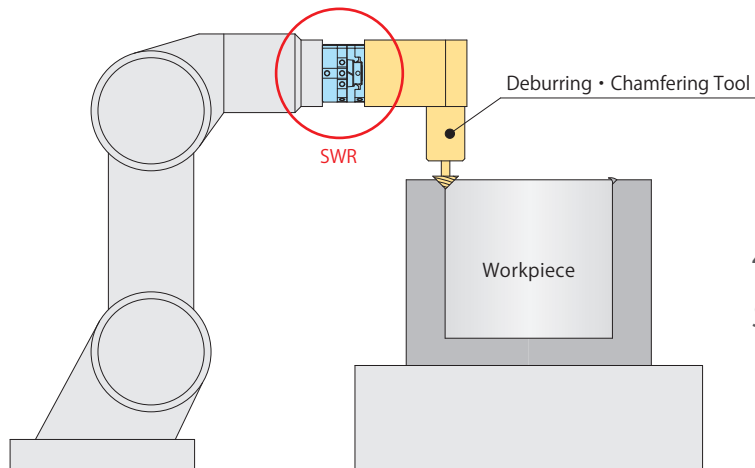

Zero Backlash

Suitable for Heavy Load Work

Before

General Robotic Hand Changer

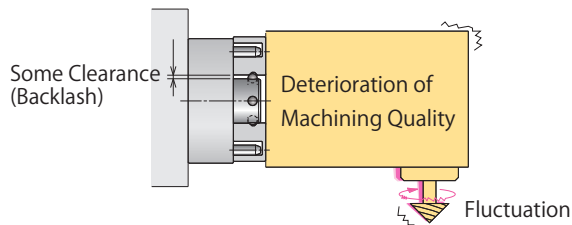

After

Kosmek Robotic Hand Changer SWR

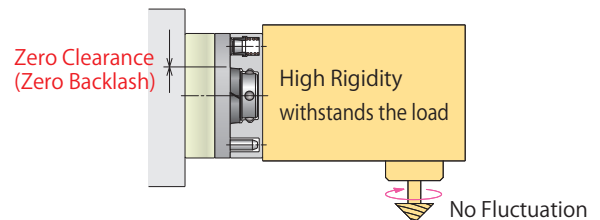

Locating Repeatability of Tool Change : $3\mu m$

Productive

Enhances Work Efficiency

No backlash on mating part is due to the dual surface mechanism with movable taper sleeve.

Circuit Connection

Supplies Air/Electricity to the Tool

Air and electrical connections to the pallet available with the air port and electrode.

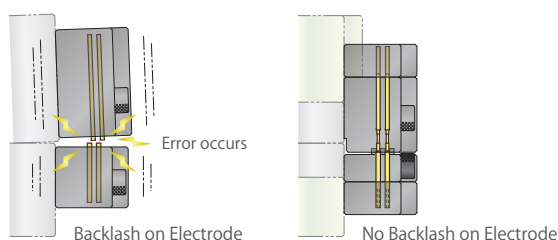

General Hand Changer

Kosmek Hand Changer

Kosmek hand changer has no backlash on electrode with dual surface contact.

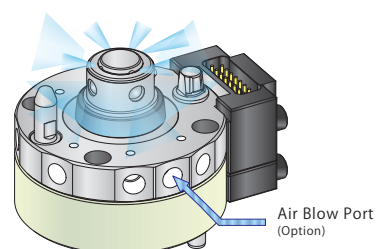

Air blow function is for cleaning the taper reference surface and seat surface.

Kosmek Robotic Hand Changer is used for

Transfer Arm Change of Press Machine Automatic Line

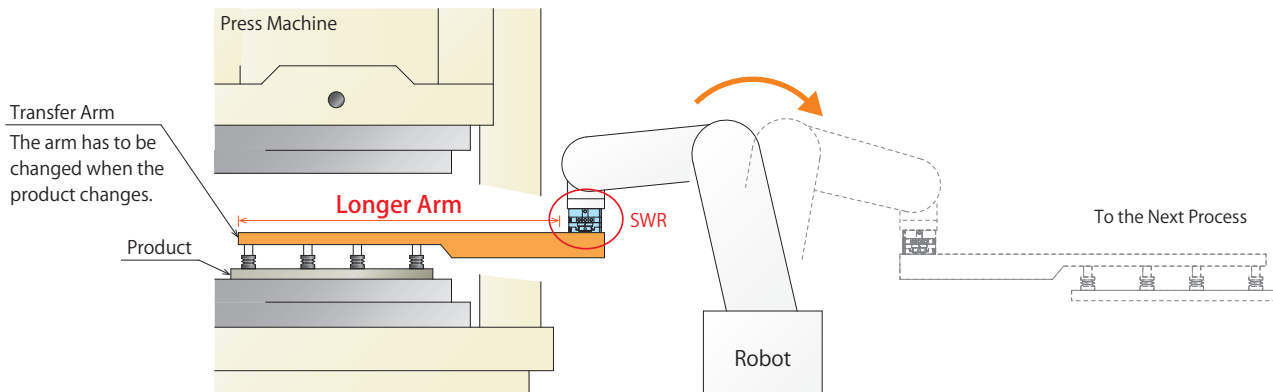

Kosmek robotic hand changer *minimizes fluctuation of the longer arm.*

Before

General Robotic Hand Changer

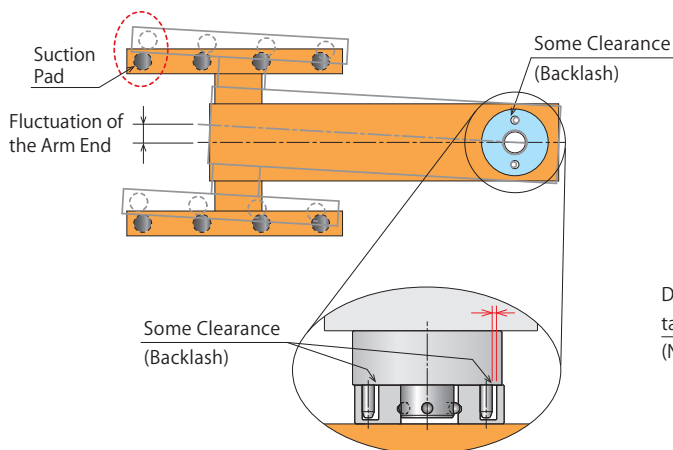

With low locating accuracy, fluctuation of the arm end becomes larger. Clearance on the hand changing part may result in gap due to the moment of robot movement. When suction pad is off-position, the pad may not adsorb products, or it cannot place products properly after transferring them.

After

Kosmek Robotic Hand Changer SWR

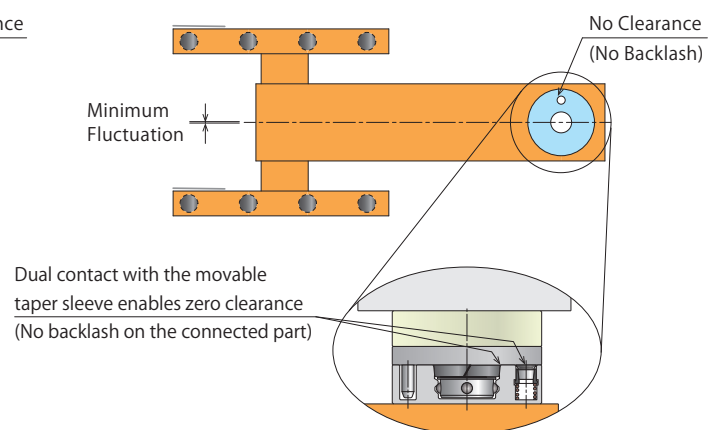

With high locating accuracy ($3\ \mu\text{m}$), fluctuation of the arm end is minimal. Since there is no clearance or backlash, the moment of robot movement does not affect attaching and detaching products. Prevent errors on attaching and detaching with high accuracy locating.

※ Drawings do not show actual dimensions.

Pneumatic Location Clamp Application Examples



Pneumatic Location Clamp is used for

Locating and Clamping of Pallet/Tray Change

Before

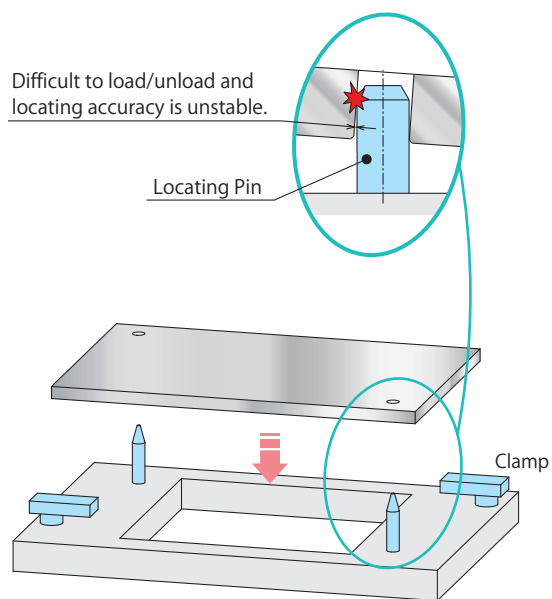

Locating Pin + Clamp

Unstable Accuracy (Locating accuracy depends on clearance.)
Since the pins interfere with holes, transfer must be highly accurate.
Space for clamps is required.

After

Locates and clamps simultaneously.

Connect the pneumatic location clamp and exclusive block.

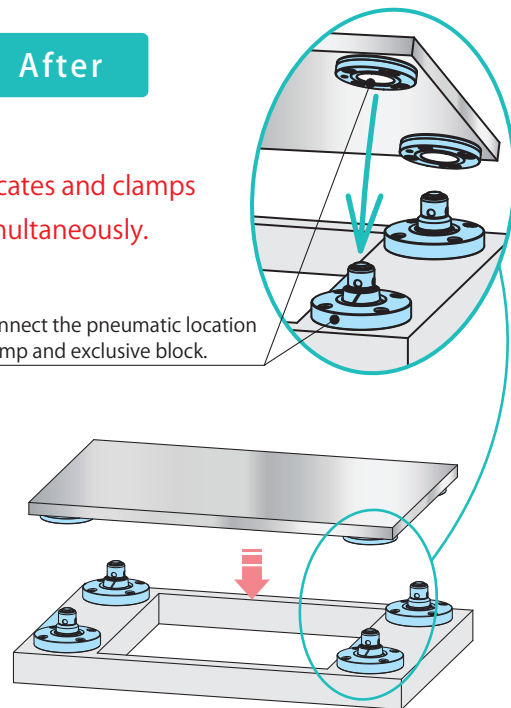

Pneumatic Location Clamp

High Accuracy (Locating Repeatability : $3\mu\text{m}$)
With lift-up function, able to set workpiece without obstruction.
Locates and clamps at the same time.

Application Example for Vacuum Facility

We are able to accommodate a fixture that does not supply air in a vacuum environment with SWTY which has the same function as SWT.

※Please contact us for use in this environment.

Example

Release with an external actuator (prepared by customer)
(Release action by lifting up a piston from the bottom of SWTY),
and lock with spring. SWTY on the fixture operates without air supply.

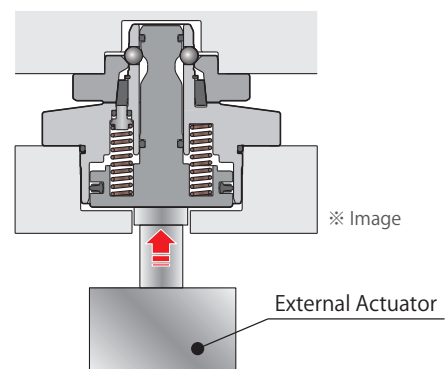

Model JVE



Model JVF



Pneumatic Location Clamp and Auto Coupler are used for

Automatic Setup Change of Engine Cold Test Device

In an engine cold test (engine function test in non-fired state), **every time an engine model changes, testing device had to be exchanged** due to the design of the testing device.

Applying pneumatic location clamp to a part (the joint part of an engine and testing device.) of testing device enables the **automatic setup exchange (time reduction in setup)** by the robot.

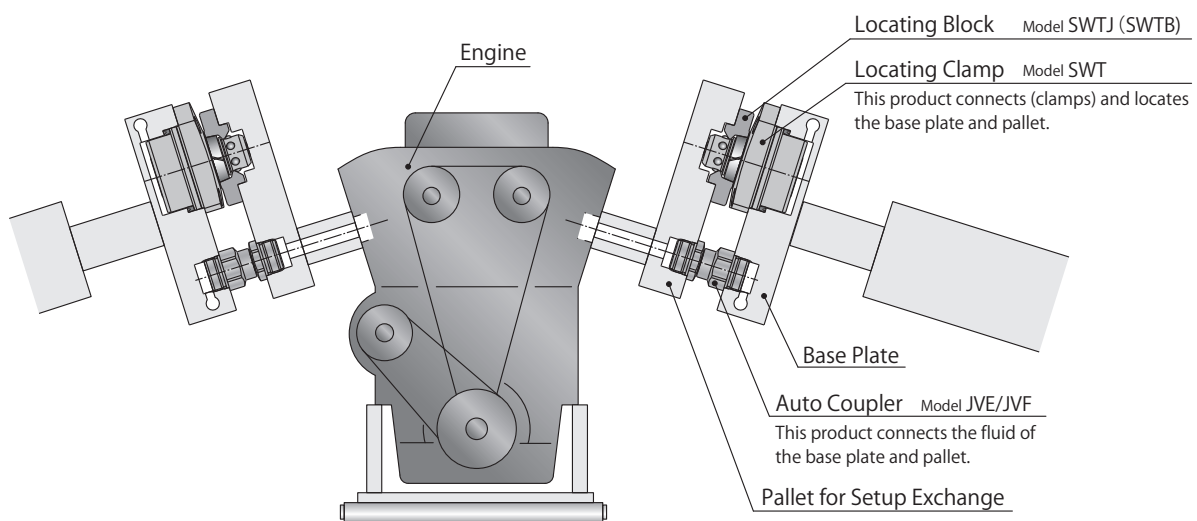

Pallet Change

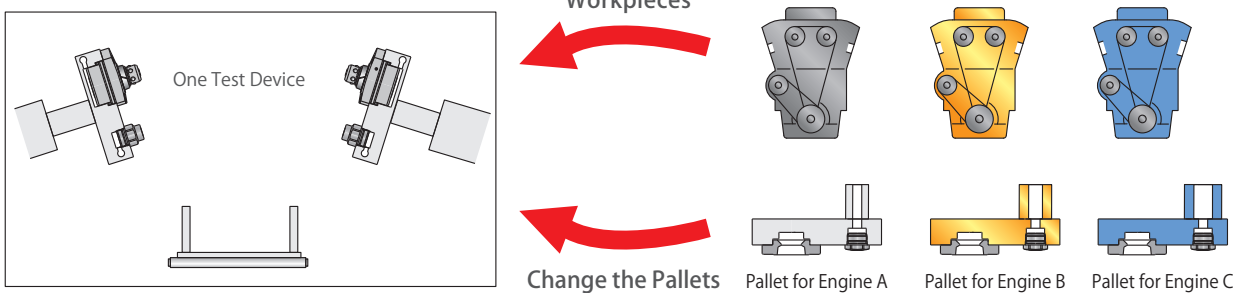

Automatic Setup with Robots

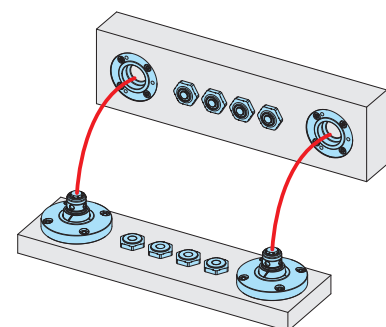
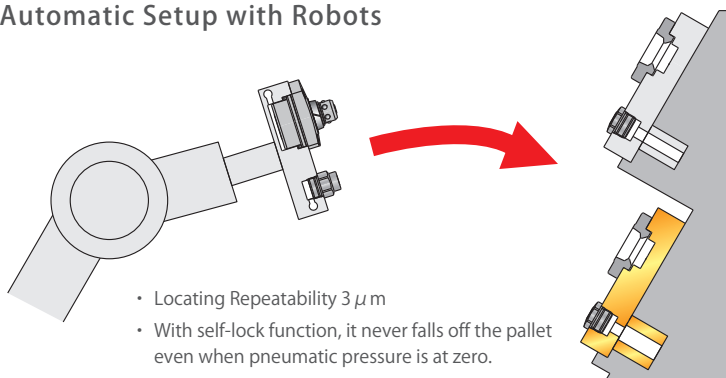

※ We offer the embedded block (model SWTB) as shown in the drawing.

Screw Locator Application Examples

NEW

M4/M5 sizes are added to the line-up!
Most Suitable for Locating Small Plates



Model VXF

Screw Locator is used for

High-Accuracy Locating for Pallet/Tray Change

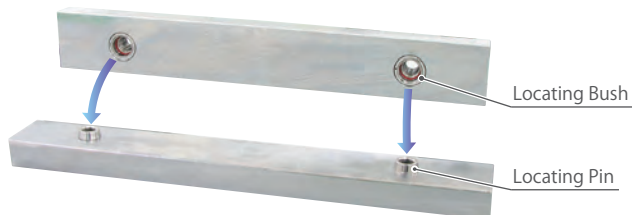

Screw Locator performs high-accuracy locating simply by fastening the bolts.

Before

General Locating Pin

Mechanical pins have **clearance** creating unreliable accuracy and repeatability.

Less accuracy due to backlash
Space is required for mounting pins.

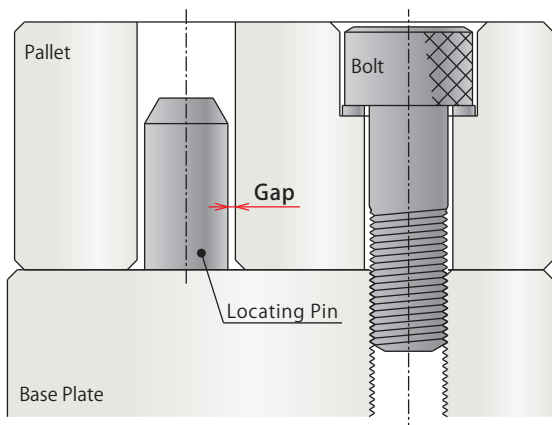

After

Screw Locator

With Dual Contact of Screw Locator

Locating Repeatability is 3 μ m

High locating accuracy makes less defective parts.
More Compact and Space-Saving

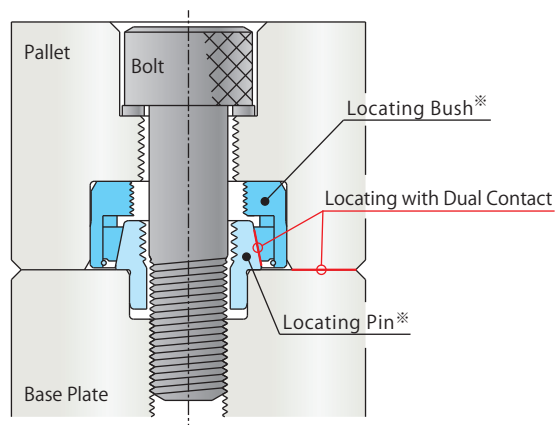

※ Screw locator consists of the locating pin and locating bush.

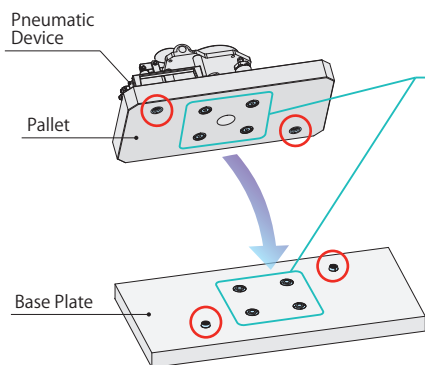

Locating Pallets • Setup Change with Screw Locator
Circuit Connection with Auto Coupler

Auto Coupler is most suitable for use with Screw Locator.

Model JVA

Model JVB

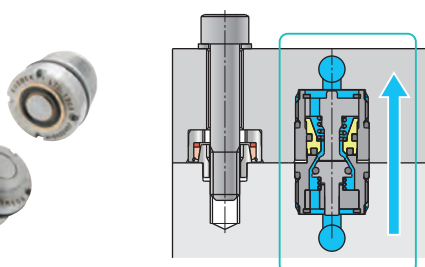

Screw Locator is used for

High-Accuracy Locating of Lower Die of Table Press Machine

Before

General Locating Pin

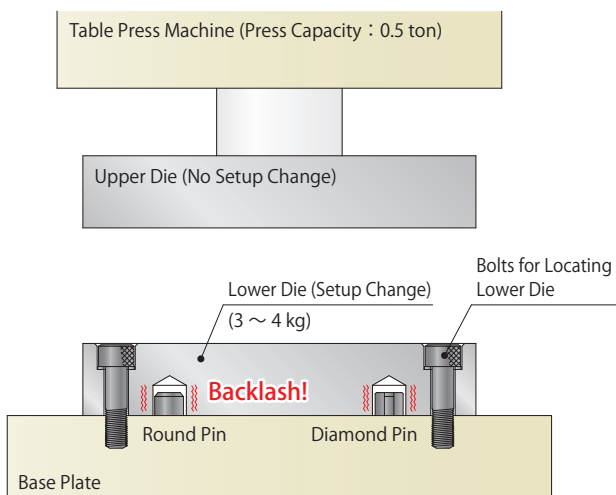

After

Screw Locator

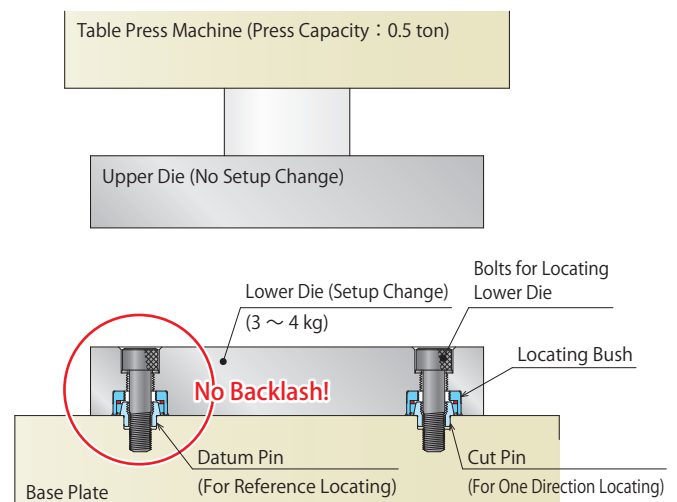

Pins and bolts are located in different places.

Requires More Space

Pins and bolts are located in the same places.

Space Saving

Locating Accuracy is low.

Requires Re-adjusting

Locating Repeatability : Within 3 μ m

Re-adjusting is not Required

Pneumatic Location Clamp enables all automated high-accuracy locating and clamping with air supply.

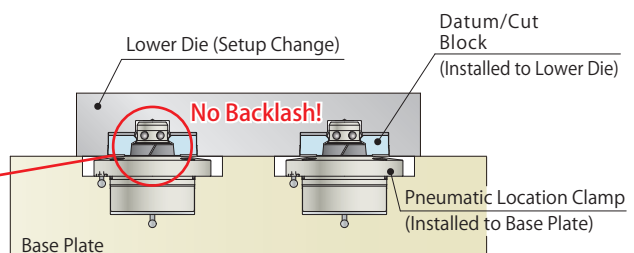

※ In this example, press load is not applied to pneumatic location clamp.
The bottom surface of lower die contacts with the top surface of base plate.

Expansion Locating Pin Application Examples



Expansion Locating Pin is used for

High Accuracy Locating for Pallet Change of Table Robot

(Equipped with Camera Module Lens etc.)

Expansion locating pin ensures high accuracy when exchanging pallets of a table robot at the situation of loading a camera module etc. leading to quality improvement and yielding resolution.

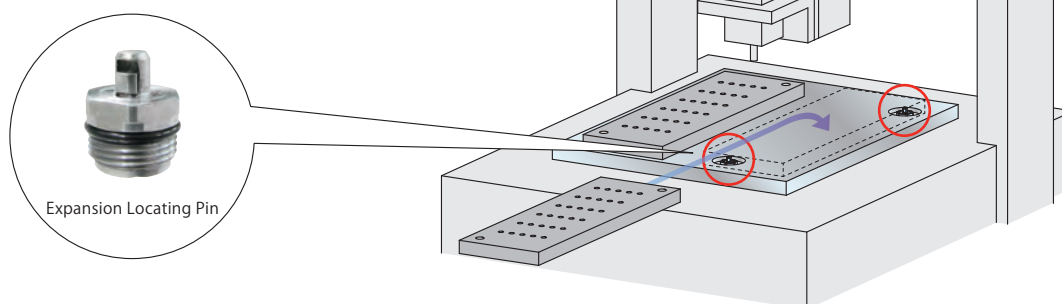

Before

General Locating Pin

Backlash

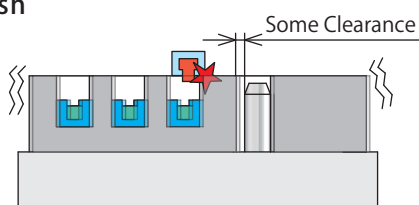

Clearance between the Pin and Hole
Displacement leads to **Malfunctions**

Locating Accuracy is low.
Accuracy Correction Required
by hand or image recognition.

After

Expansion Locating Pin

No Backlash

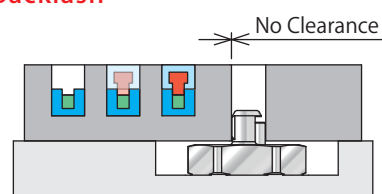

No Clearance with Pin Expansion
No Displacement, **Yield Rate Reduced**

Locating Repeatability : within $3\mu\text{m}$
No Accuracy Correction Required
since machine accuracy is improved.

Quality Improvement • Cost Reduction

Accuracy improvement of locating pin leads to high accuracy operation and cost reduction in adjustment equipment.

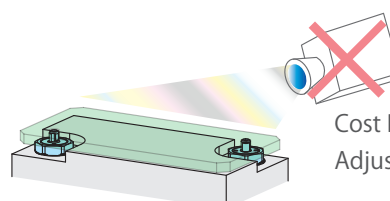

Cost Reduction in
Adjustment Equipment

Improvement in Locating Accuracy of the Machine

Expansion Locating Pin is used for

Automatic Loading • High Accuracy Locating of Pallets with Conveyor Transfer (Assembly Process for Smart Phone Components)

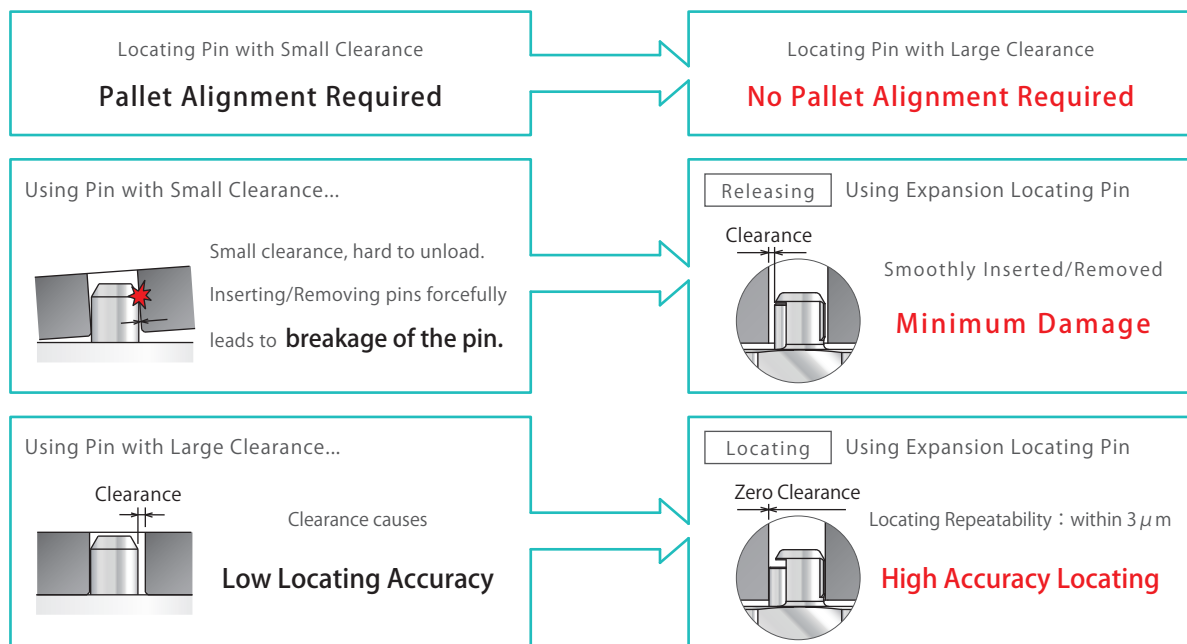
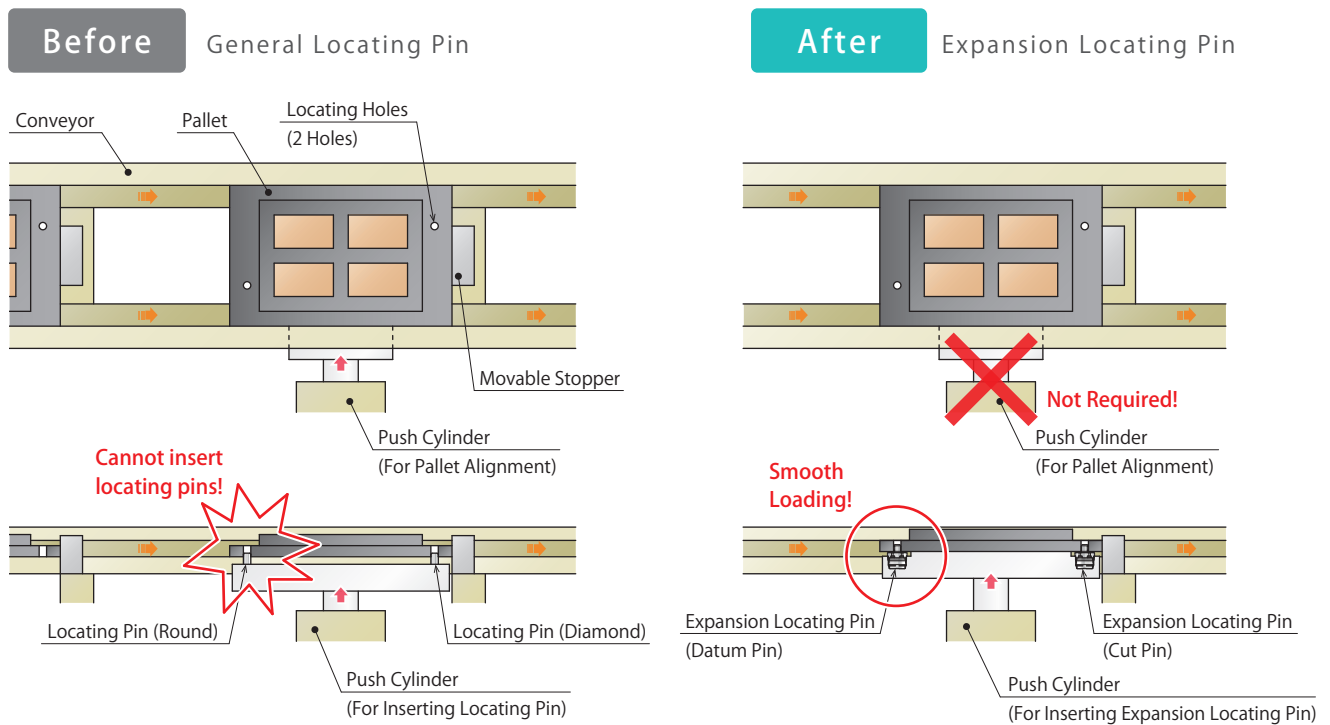

Productivity Improvement

Improvement in loading and unloading reduces errors.

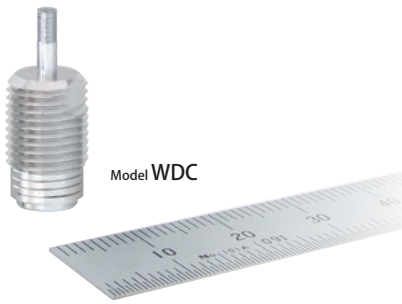

Auto Backup Pin is used for

Chattering Prevention of HDD Parts Assembly

Prevents chattering caused by assembly (press fit) and assembly defects.

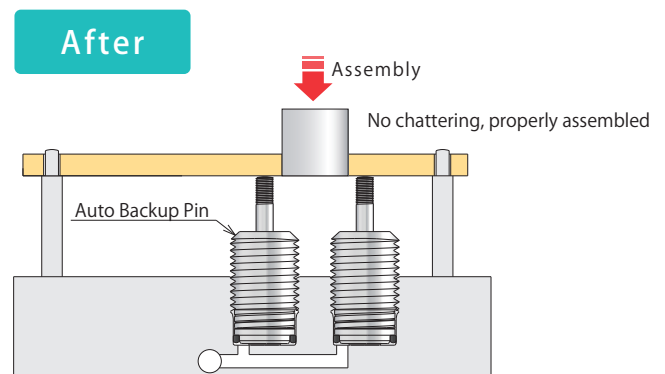
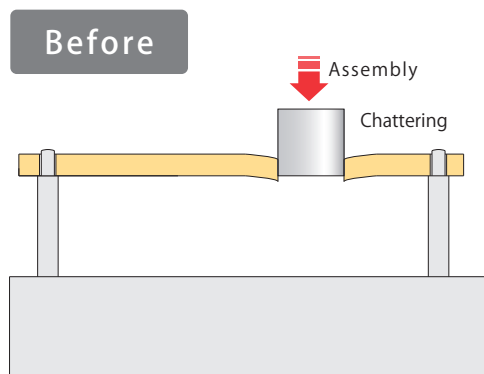
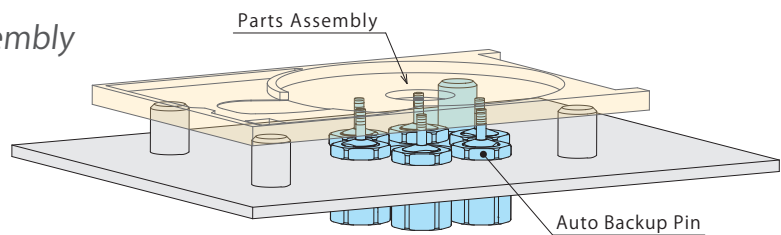

Auto backup pin contacts workpiece softly and holds it instantly (3N).
No clearance between the workpiece and pin since it follows the height of workpiece.

It enables high-accuracy implementation and yield rate reduction, since there is no clearance regardless of the variation in workpiece caused by aluminum die cast tolerances, workpiece distortion, or the gap between seat surface and tip of the pin.

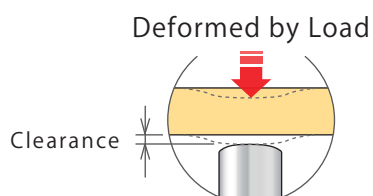

Slight Contact Force
Plunger Spring Force : 0.1~0.3N

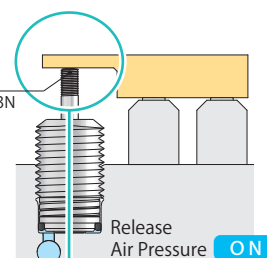

Pin descends according to workpiece.

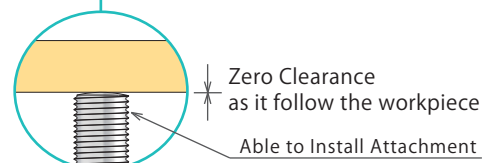

General Backup Pin

Auto Backup Pin

High-Power Pneumatic Work Support is used for

Chattering/Deformation Prevention for Finishing Process of Resin-made Components



Model WNC

High-quality resin-made electronic component requires machining for finishing process. Kosmek work support prevents deformation or chattering on thin components and enables high quality machining. It also provides shorter setup time.

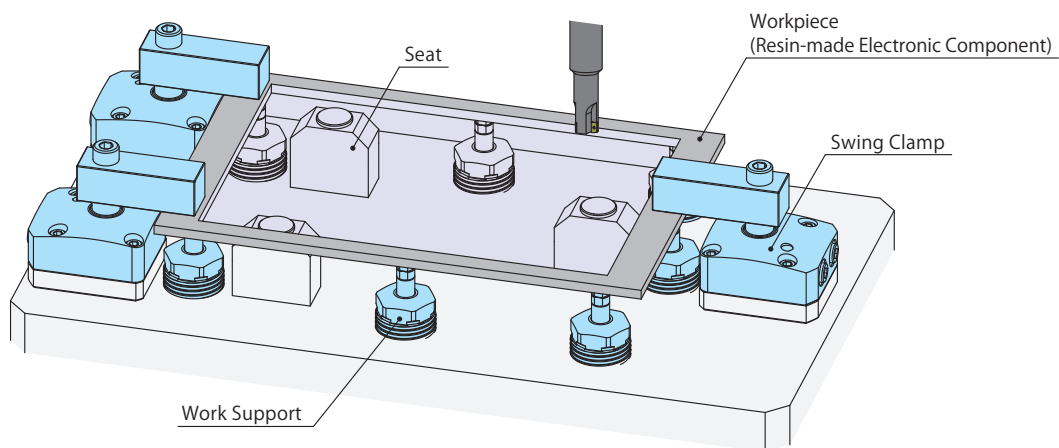

Before

Without Work Support

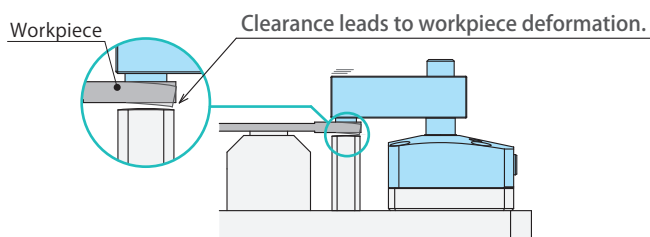

Chattering • Deformation causes
machining defect.

After

With Work Support

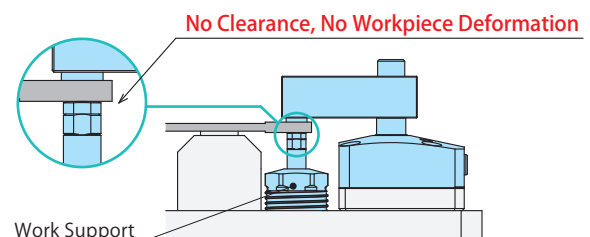

Chattering • Deformation prevention
improves machining quality.

Before

Using General Support Pin

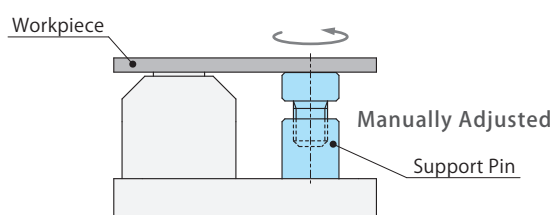

Manual adjustment requires **Setup Time**

After

Using Work Support

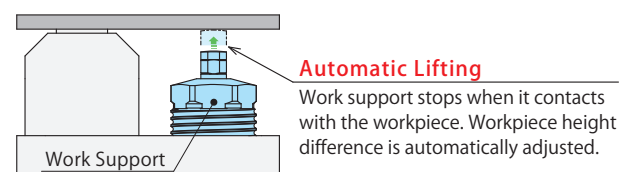

Automatic adjustment requires **No Setup Time**



High-Power Pneumatic
Swing Clamp
Model WHE



High-Power Pneumatic
Link Clamp
Model WCE

High-Power Pneumatic Clamp is used for

Fixtures with **Limited Space**

Before

General Pneumatic Cylinder

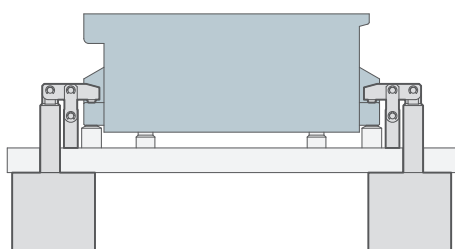

After

High-Power Pneumatic Clamp

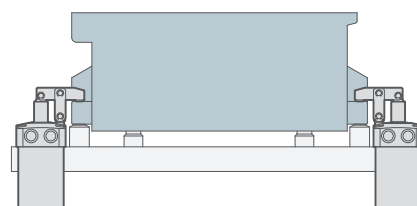

Fixture Weight
10% reduced

※ Reference when
workpiece size is 300×260

High-power pneumatic clamp has compact body yet **exerts equivalent clamping force** to our conventional model. By reducing the weight of fixture, the load to equipment will be minimized.

Before

Pneumatic Clamp
Model WHA0400

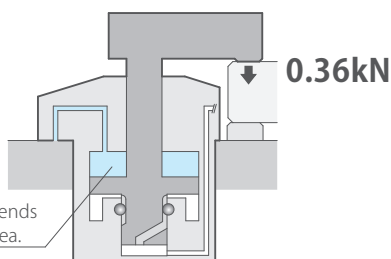

Output force depends
on the cylinder area.

After

High-Power Pneumatic Clamp
Model WHE1600

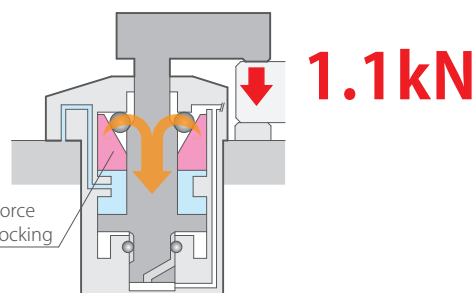

Higher Output Force
by Mechanical Locking

Strong Clamping Force with Mechanical Lock

Exerts approximately 3 times higher clamping force than the same size comparison pneumatic cylinder.

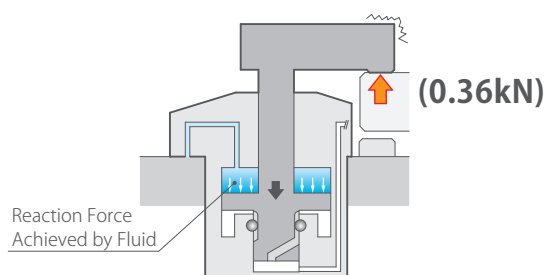

Reaction Force
Achieved by Fluid

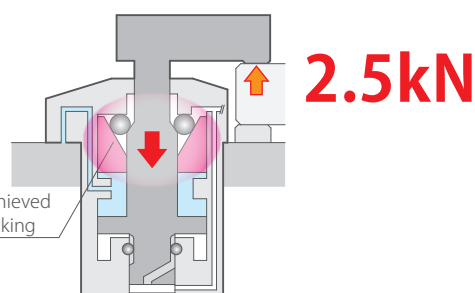

Reaction Force Achieved
by Mechanical Locking

Holding Force

Holding force is the force that endures reaction force (load), not the force that presses a workpiece.

The high holding force enables **heavy load machining and high accurate machining**.

※ Comparison of Cylinders with Piston Diameter $\phi 40$
(Air Pressure 0.4MPa, Lever Length 60mm)

Company Profile



KOSMEK LTD. Head Office

| | |
|-----------------|--|
| Company Name | KOSMEK LTD. |
| Established | May 1986 |
| Capital | ¥99,000,000 |
| Sales | 55 billion yen (period ended March 2014) |
| Chairman | Keitaro Yonezawa |
| President | Tsutomu Shirakawa |
| Employee Count | 220 |
| Group Company | KOSMEK LTD. KOSMEK ENGINEERING LTD. KOSMEK (USA) LTD. KOSMEK (CHINA) LTD. |
| Business Fields | Design, production and sales of precision products, and hydraulic and pneumatic equipment |
| Customers | Manufacturers of automobiles, industrial machinery, semiconductors and electric appliances |
| Banks | Resona bank, Tokyo-Mitsubishi bank, Ikeda bank |

Sales Offices

| | | | |
|--------------------------------|---|---|-------------------------------|
| Sales Offices across the World | Japan | TEL. +81-78-991-5162 | FAX. +81-78-991-8787 |
| | Overseas Sales | KOSMEK LTD. 1-5, 2-chome, Murotani, Nishi-ku, Kobe-city, Hyogo, Japan 651-2241 〒651-2241 兵庫県神戸市西区室谷2丁目1番5号 | |
| | USA | TEL. +1-630-241-3465 | FAX. +1-630-241-3834 |
| | KOSMEK (USA) LTD. | 1441 Branding Avenue, Suite 110, Downers Grove, IL 60515 USA | |
| | China | TEL.+86-21-54253000 | FAX.+86-21-54253709 |
| | KOSMEK (CHINA) LTD. 考世美(上海)貿易有限公司 | 21/F, Orient International Technology Building, No.58, Xiangchen Rd, Pudong Shanghai 200122., P.R.China 中国上海市浦东新区向城路58号东方国际科技大厦21F室 200122 | |
| | Thailand | TEL. +66-2-715-3450 | FAX. +66-2-715-3453 |
| | Thailand Representative Office | 67 Soi 58, RAMA 9 Rd., Suanluang, Suanluang, Bangkok 10250, Thailand | |
| | Taiwan (Taiwan Exclusive Distributor) Full Life Trading Co., Ltd. 盈生貿易有限公司 | TEL. +886-2-82261860 | FAX. +886-2-82261890 |
| | | 16F-4, No.2, Jian Ba Rd., Zhonghe District, New Taipei City Taiwan 23511 台湾新北市中和區建八路2號 16F-4 (遠東世紀廣場) | |
| Sales Offices in Japan | Philippines (Philippines Exclusive Distributor) G.E.T. Inc, Phil. | TEL.+63-2-310-7286 | FAX. +63-2-310-7286 |
| | | Victoria Wave Special Economic Zone Mt. Apo Building, Brgy. 186, North Caloocan City, Metro Manila, Philippines 1427 | |
| | Europe (Europe Exclusive Distributor) KOS-MECH GmbH | TEL. +43-463-287587-10 | FAX. +43-463-287587-20 |
| | | Schleppplatz 2 9020 Klagenfurt Austria | |
| | Indonesia (Indonesia Exclusive Distributor) P.T PANDU HYDRO PNEUMATICS | TEL. +62-21-5818632 | FAX. +62-21-5814857 |
| | | Ruko Green Garden Blok Z- II No.51 Rt.005 Rw.008 Kedoya Utara-Kebon Jeruk Jakarta Barat 11520 Indonesia | |
| | Head Office Osaka Sales Office Overseas Sales | TEL.078-991-5115 | FAX.078-991-8787 |
| | | 〒651-2241 兵庫県神戸市西区室谷2丁目1番5号 | |
| | Tokyo Sales Office | TEL.048-652-8839 | FAX.048-652-8828 |
| | | 〒331-0815 埼玉県さいたま市北区大成町4丁目81番地 | |
| | Nagoya Sales Office | TEL.0566-74-8778 | FAX.0566-74-8808 |
| | | 〒446-0076 愛知県安城市美園町2丁目10番地1 | |
| | Fukuoka Sales Office | TEL.092-433-0424 | FAX.092-433-0426 |
| | | 〒812-0006 福岡県福岡市博多区上牟田1丁目8-10-101 | |

Product Line-up

We manufacture a wide range of clamping systems and components. Feel free to contact us.



■ KOSMEK WORK CLAMPING SYSTEMS

MACHINE TOOL RELATED PRODUCTS

Our clamping system enables boltless automation making loading and unloading workpieces easier. The non-leak valve enables the use of hydraulic source and fixtures in a disconnected condition after locking (clamping action).



■ QUICK DIE CHANGE SYSTEMS

FOR PRESS MACHINES

Kosmek Quick Die Change Systems are a cost effective way to improve the working environment, allow diversified and small-lot production, and reduce press down time. Available for a wide range of machines from large size transfer-presses to smaller high speed presses.

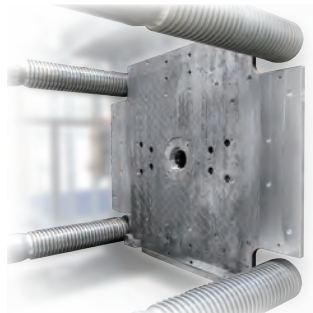

■ QUICK MOLD CHANGE SYSTEMS

FOR INJECTION MOLDING MACHINES

Automatic clamping systems have reduced mold change times and increased production efficiency for plastics manufacturers in a multitude of industries. We offer a variety of clamping options including hydraulically powered clamps, pneumatic clamps with a force multiplying mechanism, and magnetic clamping systems.

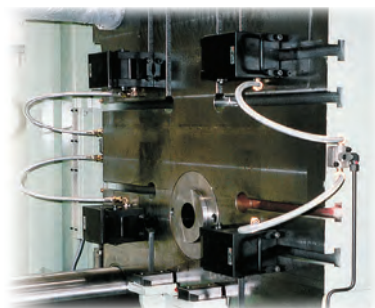

■ DIECAST CLAMPING SYSTEMS

FOR DIECAST MACHINES

Kosmek Diecast Clamping Systems (KDCS) enable stable die clamping for die casting and magnesium molding machines that are subjected to severe conditions caused by exposure to mold release agents and high temperature.

KOSMEK
Harmony in Innovation

HEAD OFFICE 1-5, 2-Chome, Murotani, Nishi-ku, Kobe 651-2241
TEL.+81-78-991-5162 FAX.+81-78-991-8787

BRANCH OFFICE (U.S.A.) KOSMEK (U.S.A.) LTD.
1441 Branding Avenue, Suite 110, Downers Grove, IL 60515 USA
TEL.+1-630-241-3465 FAX.+1-630-241-3834

THAILAND REPRESENTATIVE OFFICE 67 Soi 58, RAMA 9 Rd., Suanluang, Suanluang, Bangkok 10250
TEL.+66-2-715-3450 FAX.+66-2-715-3453

- FOR FURTHER INFORMATION ON UNLISTED SPECIFICATIONS AND SIZES, PLEASE CALL US.
- SPECIFICATIONS IN THIS LEAFLET ARE SUBJECT TO CHANGE WITHOUT NOTICE.



<http://www.kosmek.co.jp>